

BlueWind



PORTABLE INVERTER EVAPORATIVE COOLER

MANUAL



www.bluewindfans.com

THE MOST EFFICIENT AND NATURAL SOLUTION TO REDUCE THE TEMPERATURE IN LARGE SPACES





Index

1) PRESENTATION	04	11) FEATURES	26
2) SAFETY MEASURES	05	12) CLEANING AND MAINTENANCE	28
3) OPERATION AND SPECIFICATIONS	10	13) CLEANING PROCESS	29
4) MODEL BW500	10	14) MODEL BW090	34
5) MODEL BW300	12	15) INSTRUCTIONS	36
6) MODEL BW220	14	16) CLEANING AND MAINTENANCE	38
7) MODEL BW250	16	17) PRECAUTIONS	39
8) MODEL BW160	18	18) INSTRUCTIONS	40
9) MODEL BW120	20		
10) INSTRUCTIONS	22		



To ensure proper and effective use, please read this manual before operating your BlueWind evaporative cooler.

Presentation



THANK YOU FOR YOUR TRUST IN OUR PRODUCT

We master the Science of Evaporative Cooling.

The most efficient and natural solution to lower the temperature in large spaces. BlueWind fans use the principle of evaporation to transform hot air into a cool and comfortable breeze without refrigerant gases or high electricity consumption.

Designed to filter dust and improve air quality, BlueWind fans create a fresh and healthy environment without producing mist or excessive humidity.

Thanks to their advanced technology, the units deliver immediate and uniform cooling, ideal for factories, warehouses, workshops, gyms, restaurants, and more. Some models are equipped with UVC water sterilization, eliminating up to 99% of bacteria within seconds, ensuring better hygiene and safety during every cooling cycle.

Freshness and purity in every turn.





- 1** Read the entire manual before operating the cooler.



- 2** Do not open the control panel or cover without qualified personnel.



- 3** Do not touch the control panel, cable, or unit cover with wet hands.



- 4** Do not share the electrical outlet with another device due to the high starting current. Use an extension cord with a minimum diameter of 2.0 mm (14 AWG) for the cooler. The extension must not exceed 25 meters; irregular cords may cause short circuits.



- 5** Avoid using old or damaged plugs. Keep cables away from heat and fire. Do not place cables where people walk to prevent tripping or pulling accidents.



- 6** Do not remove the grounding prong from the power cord. Use a properly grounded plug. For your safety, do not alter the power cord or the wiring inside the control panel.



7

This unit is not designed and must not be used to draw in: (1) Flammable gases (including fuel gas, gasoline gas, pure oxygen, hydrogen, etc.) (2) Flammable liquids such as gas or toluene (3) Combustible dust below 80°C flash point (e.g., magnesium, platinum, gunpowder, etc.).



8

If the cooler does not function properly, turn off the unit and check the power cord, outlet, and extension cable. After inspection, restart the unit. If the problem persists, contact your dealer. Do not disassemble or replace parts yourself.



9

Place the cooler on a flat surface and make sure the brake is locked before operation. If a water leak is detected, unplug the unit immediately and move it to a safe area.



10

When the cooler will not be used for a while, open the drain valve at the bottom and activate the automatic drain to release all the water. Then turn on the unit for one to two hours to dry the filter completely. After drying, disconnect the equipment before storing it.



11

To fill the tank manually, turn off the fan and open the ice inlet, then fill it with water. Make sure the power cord is kept away from the water to prevent accidents.



12

Do not place the air inlet side (where the filter is located) near fire, smoke, ashes, cigarettes, cigars, or charcoal. Damage or accidents caused by this are not covered under warranty.



13

While operating, do not open the top cover, fan cover, or rear filter. Do not throw objects into the fan to prevent accidents.



14

Evaporative coolers are heavy—handle them carefully to avoid injury from tipping or falling.



15

Do not open the ice inlet while the cooler is operating. Getting too close to the fan blades may cause injuries or damage to the blades.



16

When cleaning, do not spray water onto the control panel or unit cover to avoid damage.



17

Do not modify, disassemble, or repair the product without proper instructions. Damage resulting from these actions is not covered by the warranty. Contact your dealer for support.



18

Do not modify or replace the fan blades yourself to prevent accidents.



19

Do not move the unit by pushing the water hose, as it may cause internal damage.



Freely adjust the fan speed using inverter power-saving control.



Move the cooler easily using its wheels.



Evaporative cooling system for natural and efficient temperature reduction.



Add ice to enhance the cooling effect.



The large water tank supports 4 to 6 hours of continuous operation.



Includes a low water level detector to prevent pump burnout.



Dust filtration provides cleaner air output.



Portable design, allowing you to move it wherever needed.



Strong and well-designed plastic structure.



Energy-efficient, cools large areas faster.



MODEL: BW500

SPECIFICATIONS

Model	BW500	Maximum Rotation Speed	660 RPM	Maximum Air Range	30 m
External Frame	PE	Noise Level (Max)	75 dB	Dimensions	L180 × W88 × H220 cm
Blades	50" – 3 Fiberglass Blades	Voltage (Reg)	1 Ø 220V, 60 Hz	Water Capacity	230 L
Motor	2HP F Grade	Max Current	7.6A ±10	Weight	185 kg
Poles	10P	Max Power Consumption	1150 W/hr ±10	Weight with Water	390 kg

(The sound volume data is detected from 3 meters and will be verified in different nearby areas)

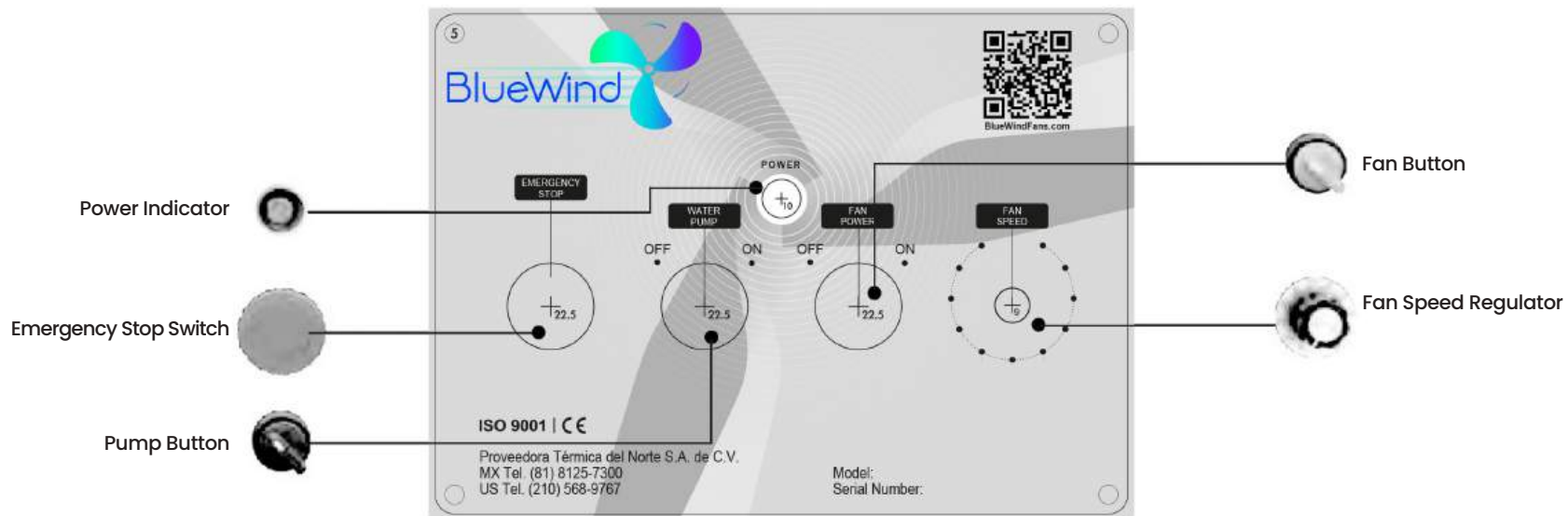

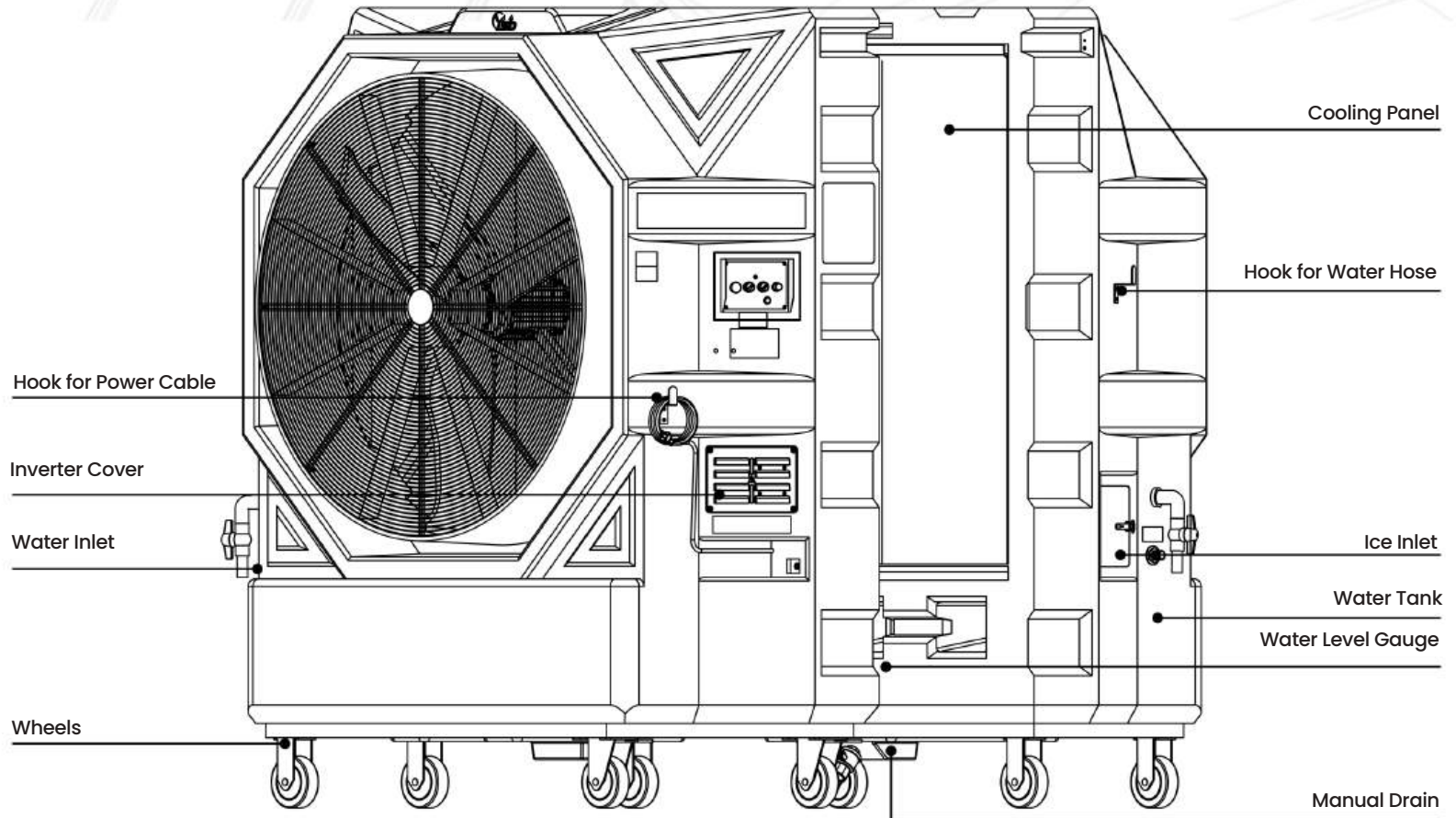

MODEL: BW500



MODEL: BW300

SPECIFICATIONS

Model	BW300	Maximum Rotation Speed	580 RPM	Maximum Air Range	25 m
External Frame	PE	Noise Level	70 dB	Dimensions	L155*W81*H186 cm
Blades	42" 6 Nylon 6 + Fiber Blades	Voltage	1 Ø 220V, 60Hz	Water Capacity	180 L
Motor	1.5HP F Grade	Max Current	7.6A ±10	Weight	120 kg
Poles	10P	Max Power Consumption	1050 W/hr ±10	Weight with Water	300 kg

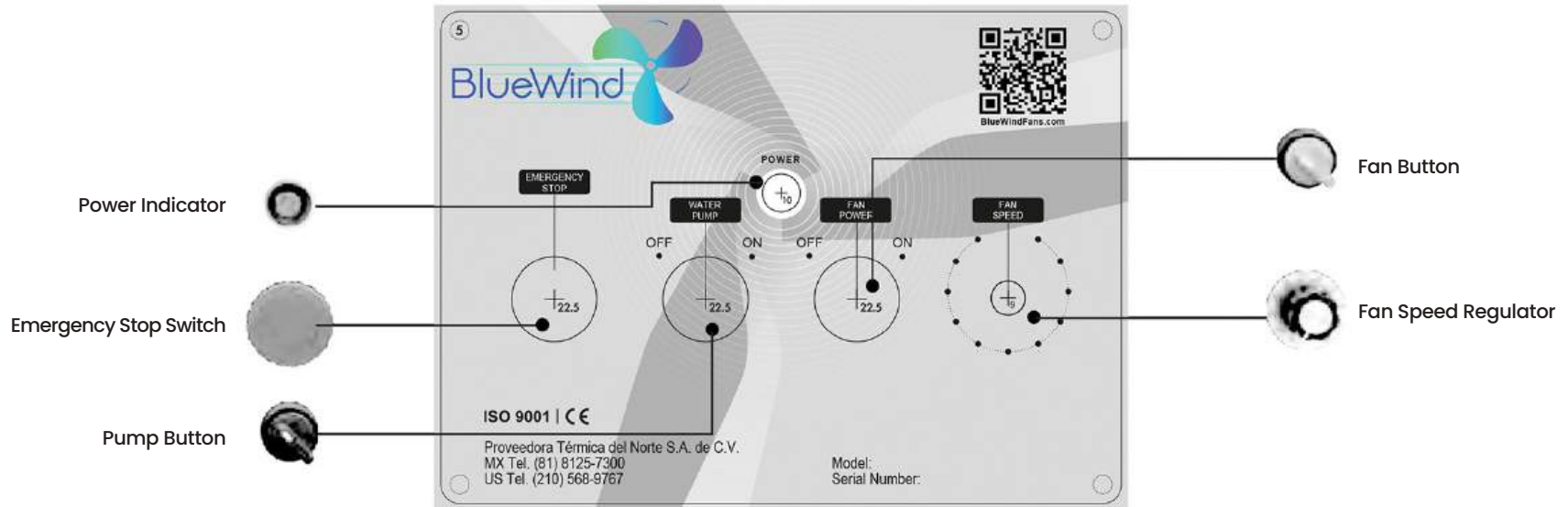

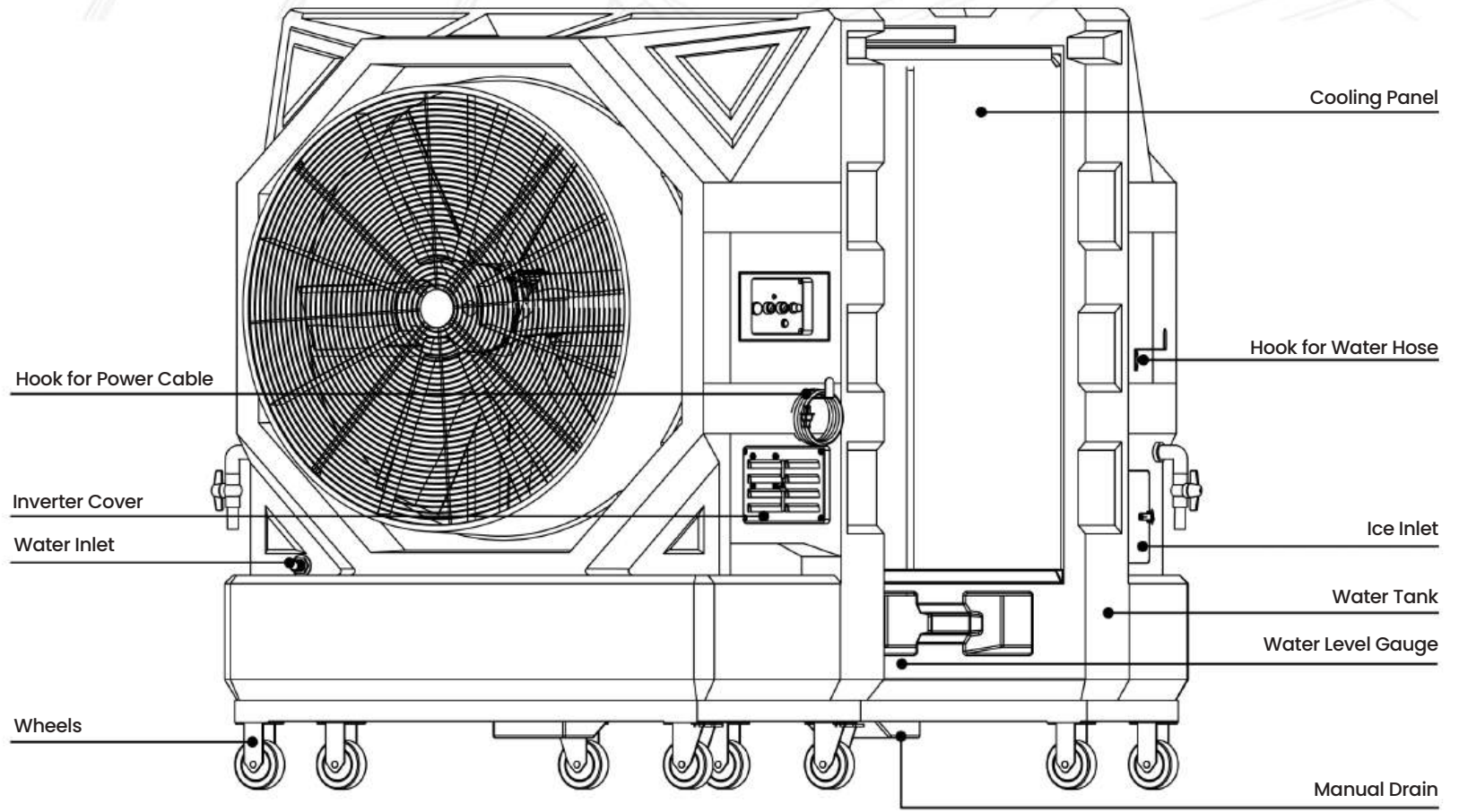

MODEL: BW300



MODEL: BW220

SPECIFICATIONS

Model	BW220	Maximum Rotation Speed	1000 RPM	Maximum Air Range	20 m
External Frame	PE	Noise Level	65 dB	Dimensions	L126*W72*H160cm
Blades	30"-3 Nylon 6 + Fiber Blades	Voltage	1Ø 110V, 60Hz	Water Capacity	145 L
Motor	1/2 HP F Grade	Max Current	10A±10	Weight	90 kg
Poles	10P	Max Power Consumption	740 W/hr ±10	Weight with Water	235 kg

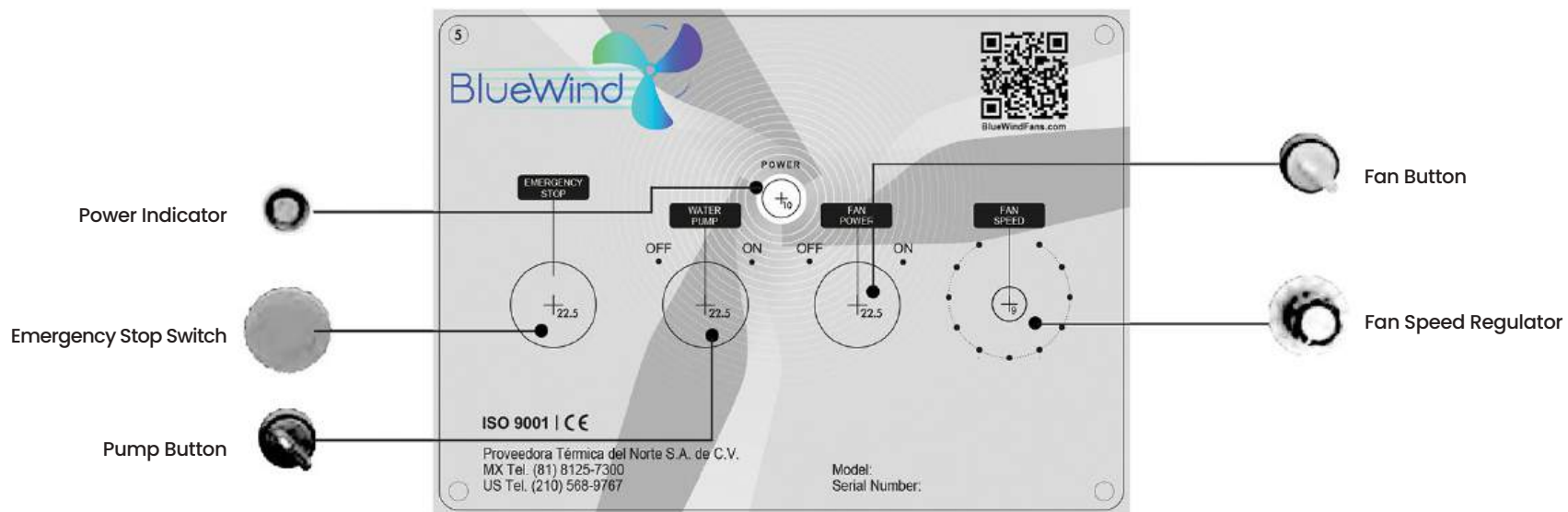

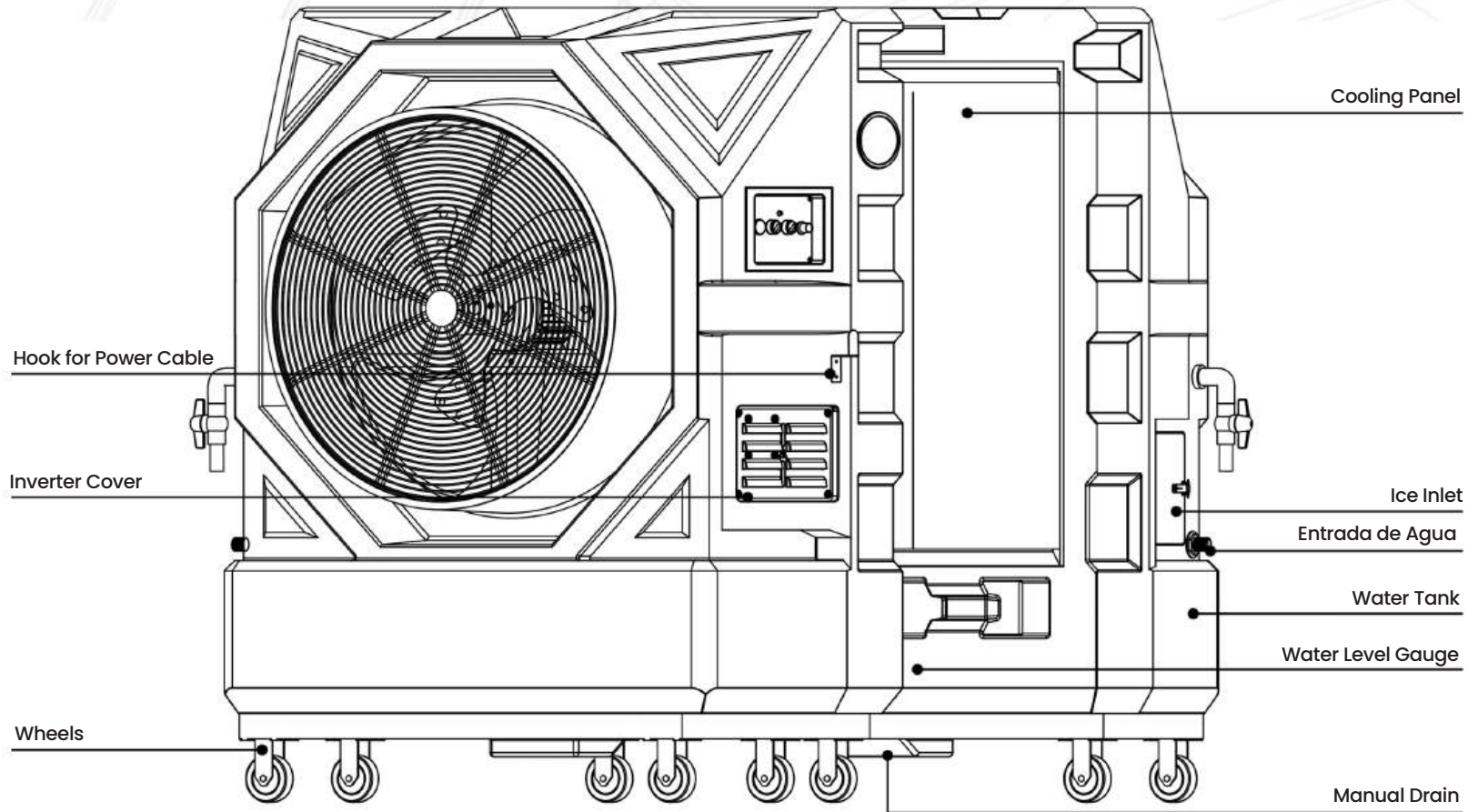

MODEL: BW220



MODEL: BW250

SPECIFICATIONS

Model	BW250	Maximum Rotation Speed	1100 RPM	Maximum Air Range	20 m
External Frame	PE	Noise Level	60 dB	Dimensions	L132*W69*H172 cm
Blades	30" - 3 Nylon 6 + Fiber Blades	Voltage	1 Ø 110V, 60Hz	Water Capacity	170 L
Motor	1/2HP F Grade	Max Current	12A ±10	Weight	100 kg
Poles	6P	Max Power Consumption	970 W/hr ±10	Weight with Water	270 kg

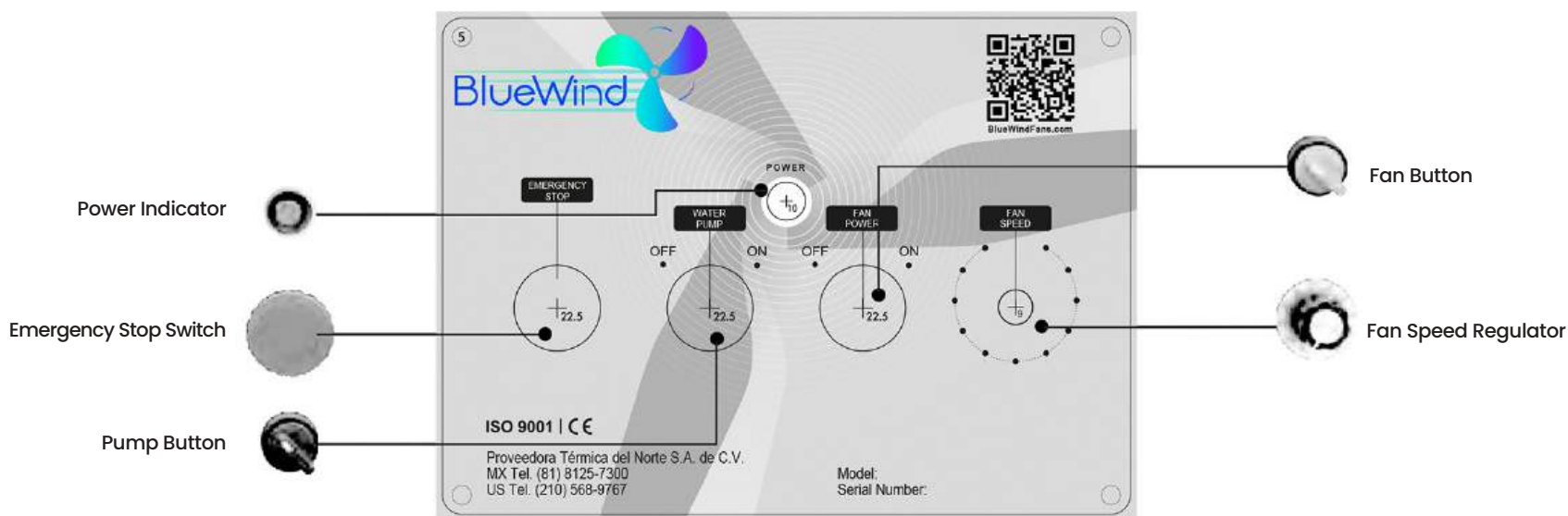

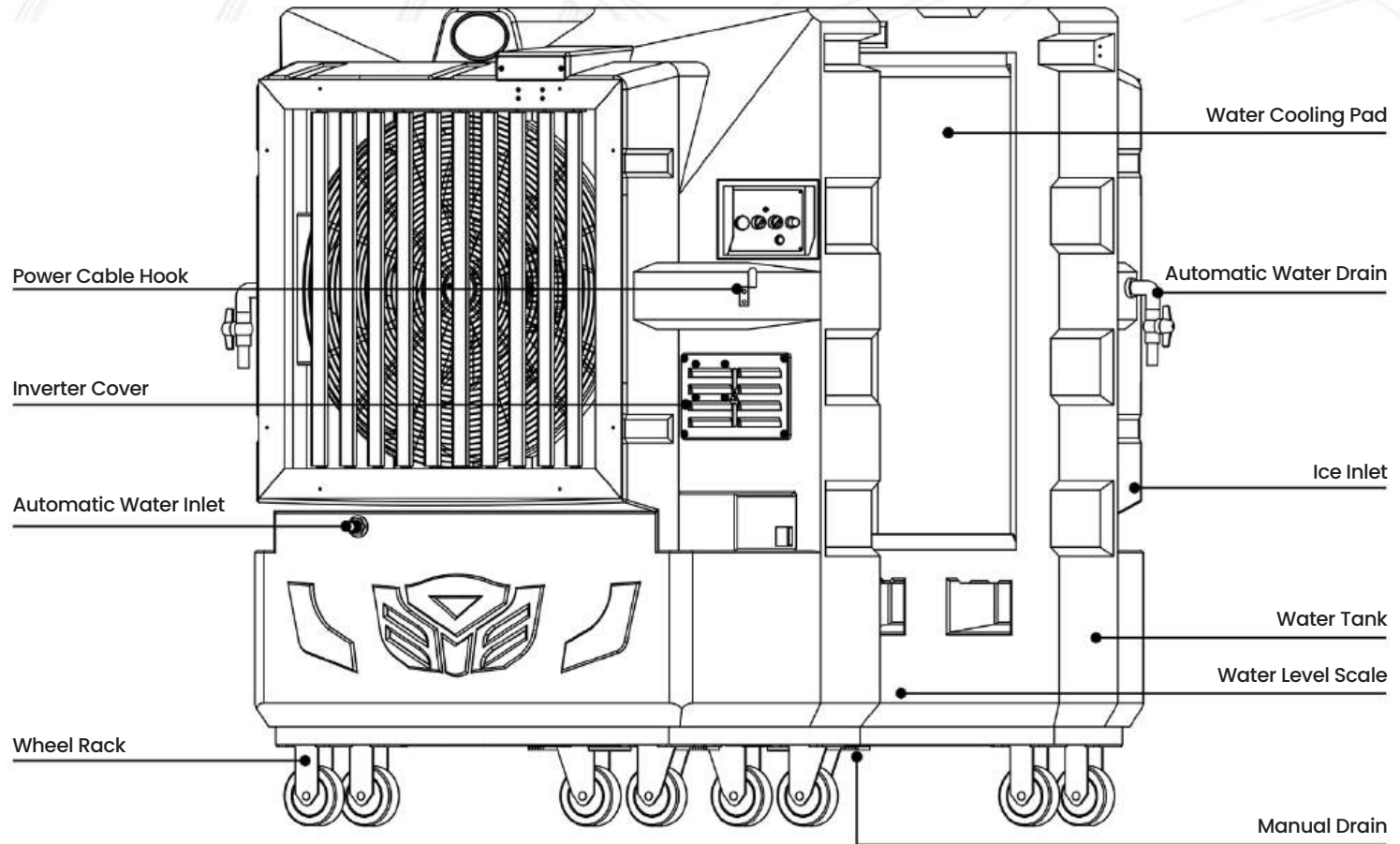

MODEL: BW250



MODEL: BW160

SPECIFICATIONS

Model	BW160	Maximum Rotation Speed	1100 RPM	Maximum Air Range	15 m
External Frame	PE	Noise Level	55 dB	Dimensions	L98*W70*H141 cm
Blades	24" - 3 Nylon 6 + Fiber Blades	Voltage	1Ø 110V, 60Hz	Water Capacity	120 L
Motor	1/2 HP F Grade	Max Current	8.5A±10%	Weight	75 kg
Poles	6P	Max Power Consumption	690 W/hr ±10	Weight with Water	195 kg

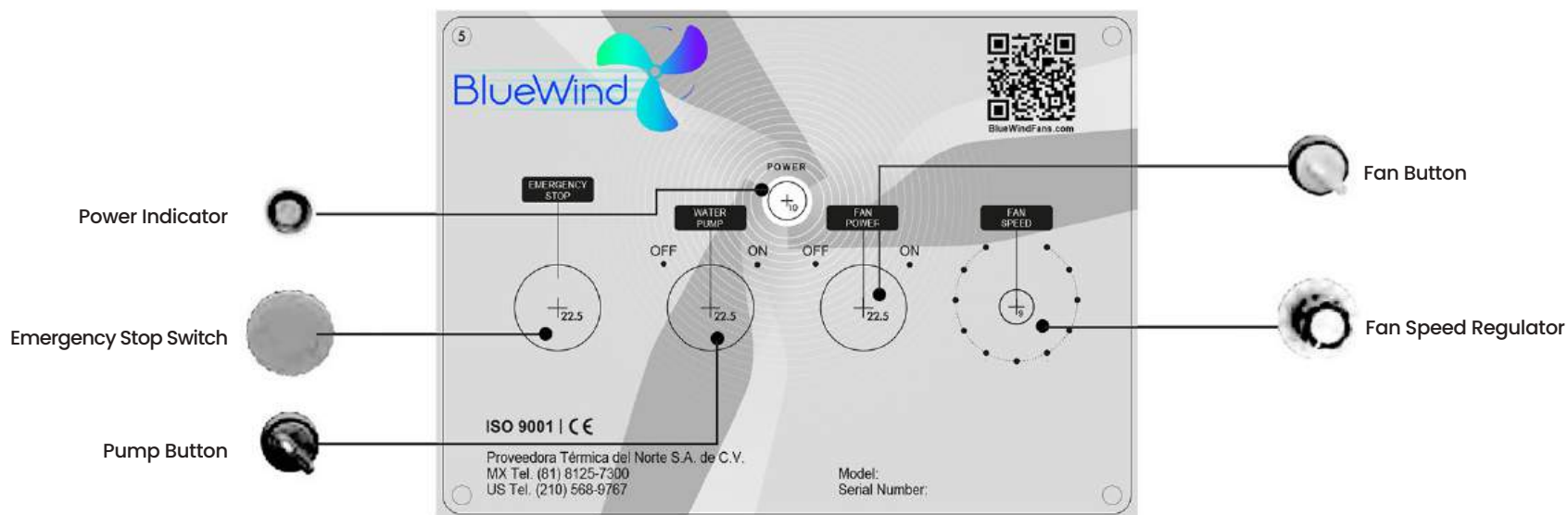

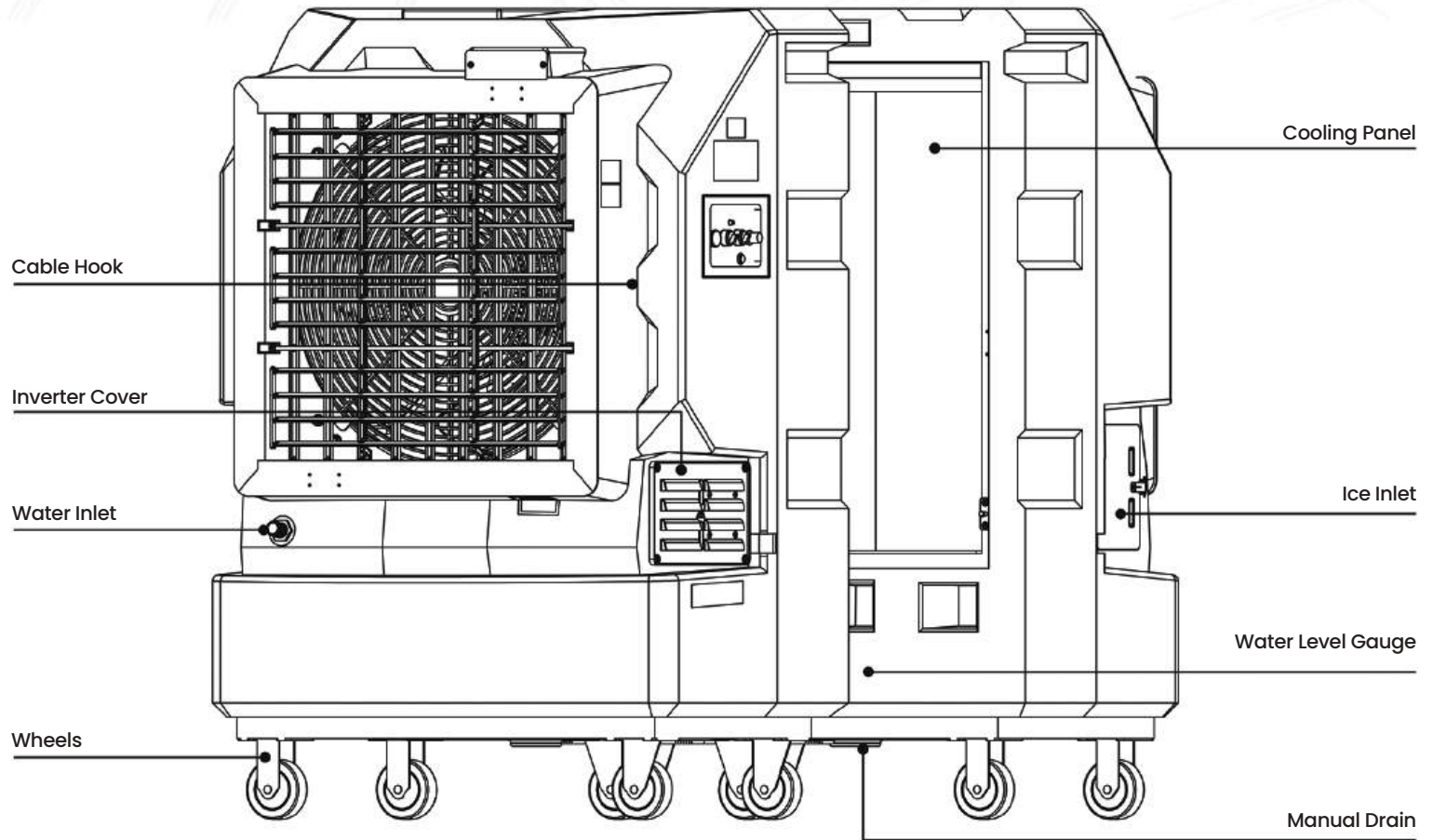

MODEL: BW160



MODEL: BW120

SPECIFICATIONS

Model	BW120	Maximum Rotation Speed	1380 RPM	Maximum Air Range	15 m
External Frame	PE	Noise Level	55 dB	Dimensions	L74*W50*H130cm
Blades	18" 3 Nylon 6 + Fiber Blades	Voltage	1 Ø 110V, 60Hz	Water Capacity	60 L
Motor	1/3HP F Grade	Max Current	6.1A ±10	Weight	45 kg
Poles	4P	Max Power Consumption	510 W/hr ±10	Weight with Water	105 kg

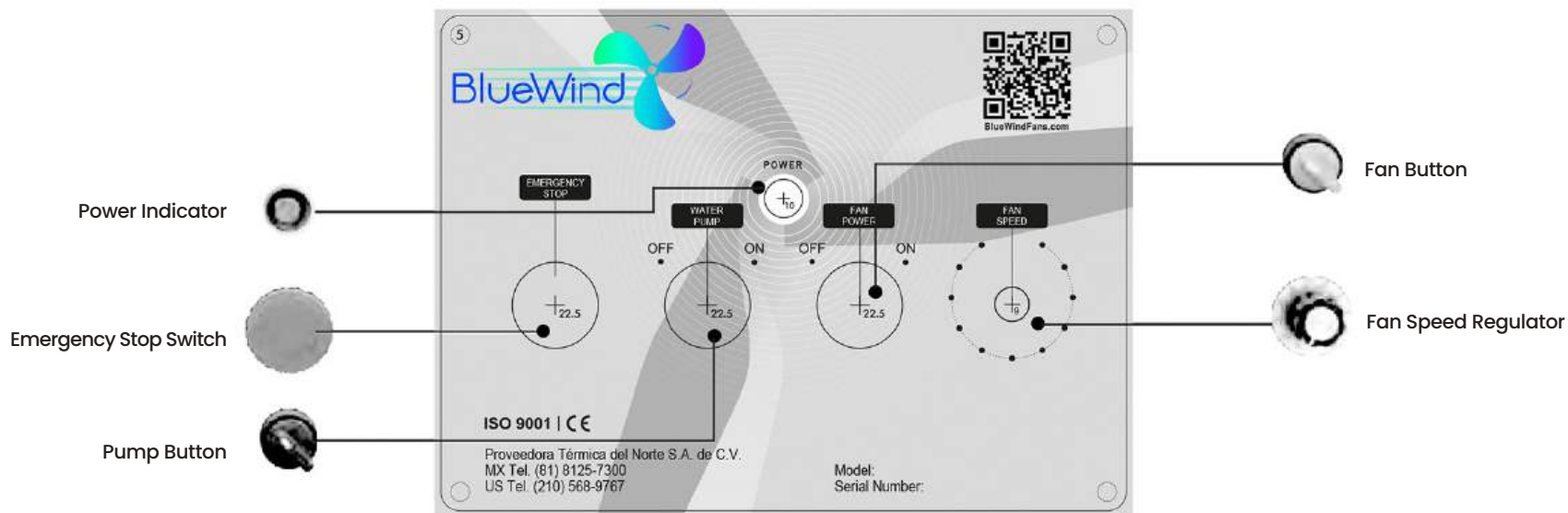

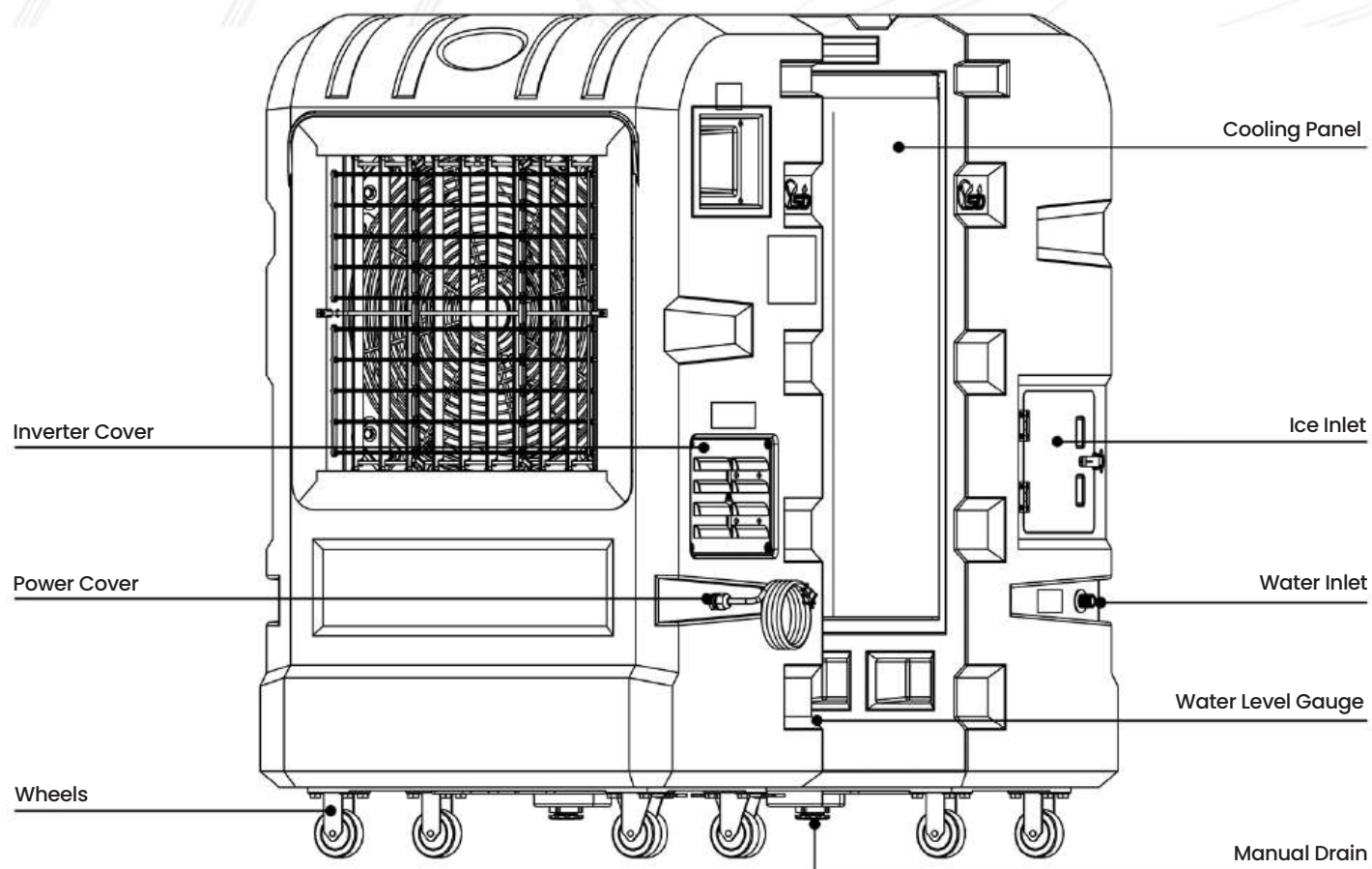



MODEL: BW120



INSTRUCTIONS

1 Please follow the instructions below:

- A  Connect the unit to AC 110V or AC 220V, 50/60 Hz single-phase power. (The product has a label indicating the proper voltage.)
- B  The voltage must not deviate more than ±10% from the indicated rating.
- C  Recommended operating temperature: 0°C to 45°C (32°F–113°F). Do not place the unit near heat or fire sources.

2 When the water level in the tank drops, the pump will automatically shut off. Fill the tank to the maximum level, but do not overfill.

3 Do not stand, sit, or place objects on the unit. This could cause damage, falls, or injuries if objects fall off.

4 After using the ice bucket, make sure to close it securely.

5 Do not remove the safety cover or any parts of the fan – doing so could cause damage or injury.

6 Use a properly insulated outlet or cable for the fan. Do not share the power source with other high-consumption equipment to ensure safety.

7 When the pump is off, the cooler can still function as a fan.

8 For better cooling performance, clean the filter and replace the tank water once a week. Open the manual drain valve at the bottom, then refill the tank after cleaning to prolong the pump's life. When the pump is turned off, the cooler can still be used as a fan only.



A. Caution: Before cleaning, turn off the unit, unplug it, and move it away from the power source and other devices.



B. Open the bottom drain and wash the filter with a soft brush from top to bottom. After washing, let the residual water drain completely before closing the drain.



C. Clean the unit with a damp cloth—do not spray water or use volatile liquids.



D. When cleaning the filter, do not spray water directly onto the control panel or housing. Doing so may damage the motor controller.



INSTRUCTIONS

9 Warranty Exclusions – The following damages are not covered:

- A. Use with incorrect voltage.
- B. Damage caused by mishandling or transport by the user.
- C. Damage caused by natural disasters.
- D. Structural damage due to volatile liquids or gases.
- E. Accidents or damage caused by cable connection issues or sharing electricity with other devices.
- F. Damage caused by modification or alteration of parts.
- G. Malfunction caused by changing internal wiring.
- H. Damage caused by spraying water or rain exposure.
- I. Pump failure due to blockage from lack of cleaning.



Contact your dealer for more information.



Stepless fan speed control

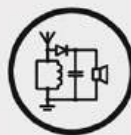

Short-circuit protection



Soft start motor



Low-water-level protection



Overcurrent protection



INSTRUCTIONS





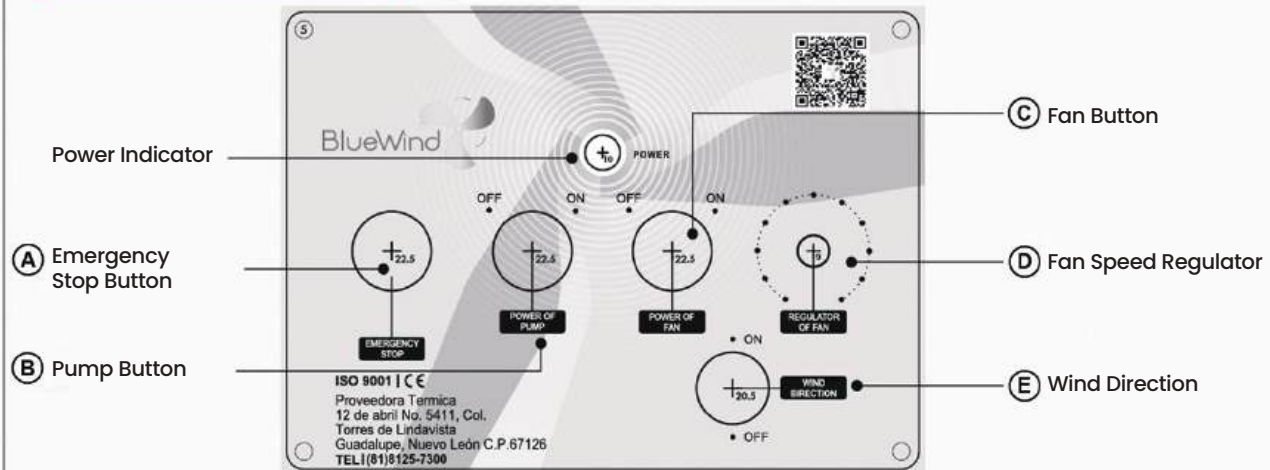

Operation and Water Filling Process:

•Connect the quick hose connector to a water supply and tighten it. Ensure the other end is securely attached to the cooler. Open the water tap and fill the tank until it reaches the maximum level on the gauge. Turn on the pump (see control panel instructions below). Let the water soak the cooling pad for 1–2 minutes, then turn on the fan and adjust speed as needed. Following this process ensures optimal cooling performance.

Control Panel Overview:





A		Power / Emergency Stop	<ul style="list-style-type: none"> • Rotate the knob to turn on the power indicator. • Press the button to turn off the unit in case of emergency. For normal use, follow standard power on/off procedure. • Note: After pressing the emergency stop, wait 20 seconds before restarting the fan.
B		Water Pump Function	<ul style="list-style-type: none"> • When power is on, the pump starts automatically once the tank has sufficient water. • The pump will not start if the water level is low. Fill the tank before operation.
C		Power of Fan	<ul style="list-style-type: none"> • Turn on the power button; the pump will start once there is enough water in the tank. The pump will not start when the water level is low. Fill the tank before use.
D		Fan Speed Regulator	<ul style="list-style-type: none"> • Adjusts the airflow intensity from 0 to 100. Higher numbers equal higher fan speed.
E		Shutter Control	Controls the air shutters (if equipped).

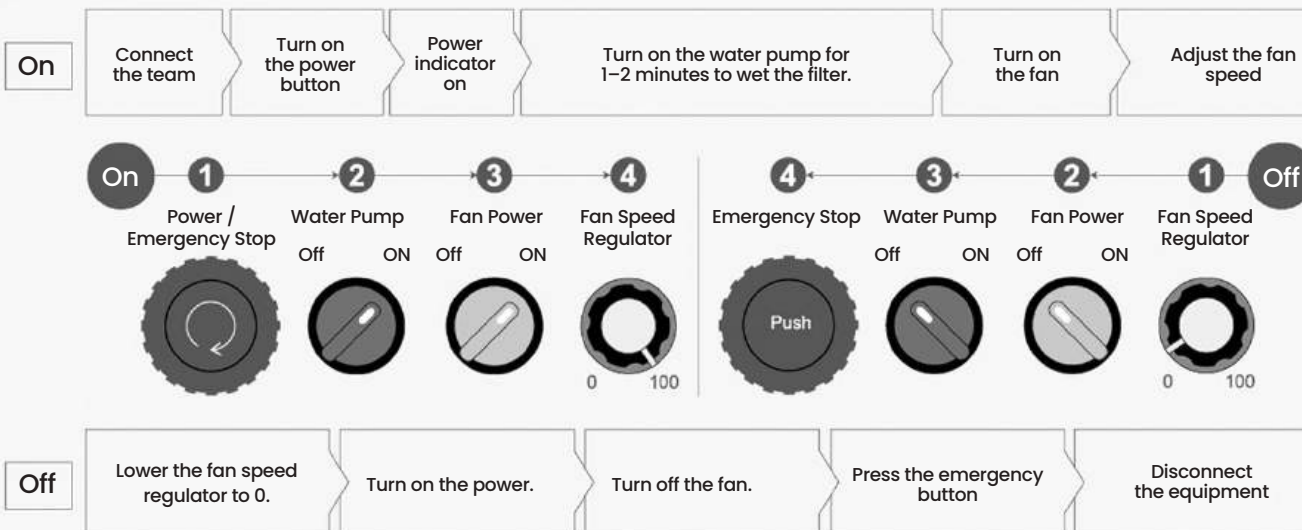



ELECTRICAL SPECIFICATIONS



LABEL INSTRUCTION GUIDE



ⓘ Current Specifications



ⓘ Current Specifications



ⓘ This area houses the inverter and fan controller. Clean the fan with a damp cloth only – spraying water directly may cause electrical leakage or short circuits.



ELECTRICAL SPECIFICATIONS

LABEL INSTRUCTION GUIDE



- Do not open the tank door before disconnecting the power supply.



- Do not touch or approach the fan when the unit is running.



CLEANING AND MAINTENANCE



ATTENTION!
Before cleaning, turn off the unit, unplug it, and move it away from the power source.

CHANGE THE WATER REGULARLY



- 1 During use, dust and particles may accumulate inside the tank. This can reduce cooling efficiency and cause unpleasant odors. It is recommended to change the tank water at least once per week, or more frequently if needed. Do not spray water directly onto the inverter or control panel.
- 2 Because the unit filters dust and particles from the air, it's important to drain the water manually after each use in poor air environments. Refill the tank before the next use.
- 3 **Manual Drain**
To drain manually: Turn the drain knob located at the bottom of the unit to release the water. When finished, turn the knob again to close it.

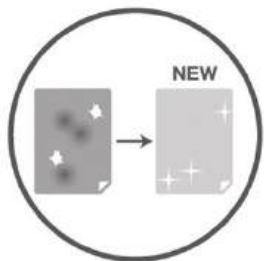

Filter Replacement:

Contact your distributor when the filter becomes stained or torn.

Water Maintenance:

Always replace the water regularly to ensure hygiene and prevent odor.



UV LIGHT CLEANING PROCESS

- 1 Before starting, press the red Emergency Stop button.

Do not open the tank door
before disconnecting the unit.

Unplug the power cord to
prevent electrical shock.

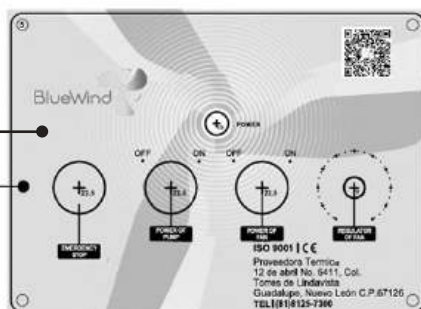

Emergency Stop

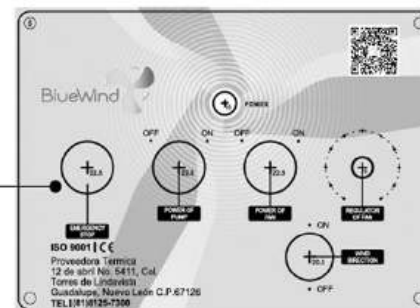

- 2 Once the unit is safely disconnected,
you can begin the cleaning procedure.

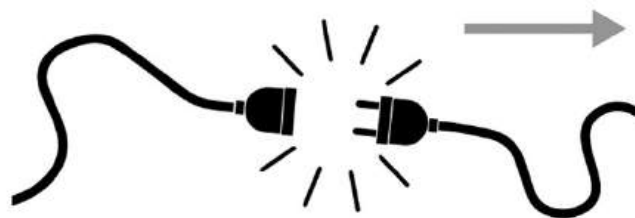



UV LIGHT CLEANING STEPS

After ensuring the cooler is unplugged, follow these steps:

- 3** Open the ice inlet and loosen the quick connector of the ultraviolet (UV) light tube.

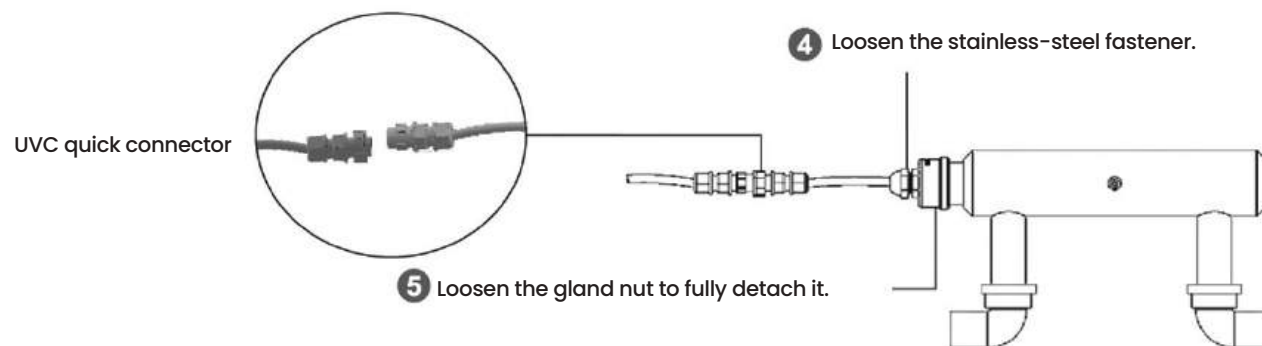

- 6** Remove the UVC light tube carefully.

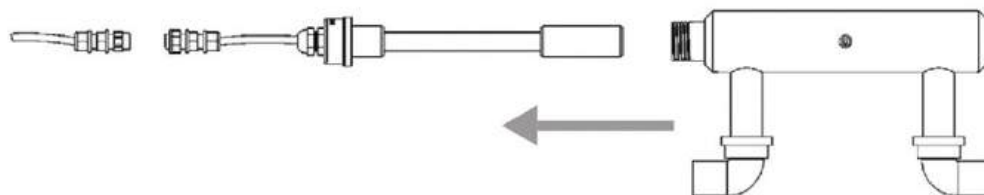



UV LIGHT CLEANING STEPS

- Prepare a container that fits the UV tube. Rinse the tube with white vinegar or a citric acid solution.
- After about one hour, any scale or mineral buildup should be dissolved. The required time may vary depending on the scale thickness. Suggested Cleaning Solution: 1 part white vinegar to 7 parts water, or 2.5 grams of citric acid per 100 ml of water.

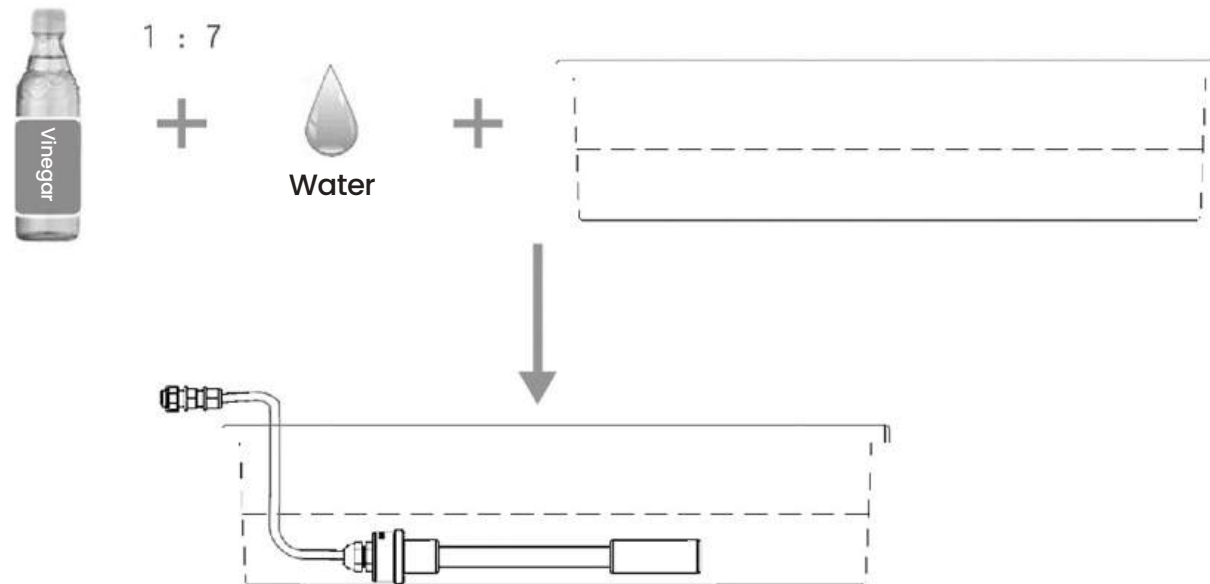



UV LIGHT CLEANING STEPS

- 8 After cleaning, rinse the UV tube thoroughly with water to remove any remaining solution. Then, place the UV light tube back into its original housing position.

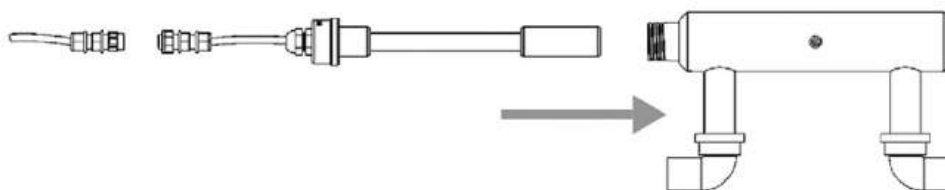

- 11 Reconnect the quick connector securely and tighten it properly.

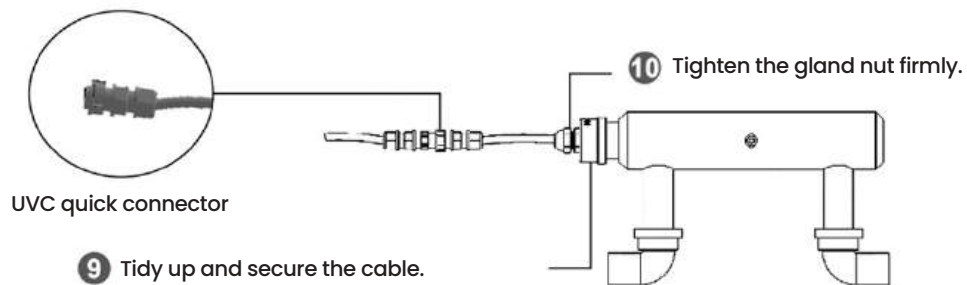

- 12 Once the UV tube is installed, close the ice inlet to complete the process.



UV LIGHT CLEANING STEPS



Precaución:

- 1 Please read this manual carefully. Damages or injuries caused by improper use are not covered by the warranty.
- 2 BlueWind is not responsible for any accidents resulting from unauthorized modifications made by users.
- 3 If you notice any damage caused during transportation, contact your distributor for assistance.
- 4 To prevent accidents or damage, follow these rules:
Learn how to operate the unit correctly before use.
Read the entire user manual and understand all operating instructions.
Review all safety and label instructions before operating.

The contents of this manual, including product design and specifications, are subject to change without prior notice.
This manual is protected by law. All rights reserved by BlueWind.



MODEL: BW090

Model	BW090	Maximum Rotation Speed	1480 RPM	Maximum Air Range	10 m
External Frame	PE	Noise Level	55 dB	Dimensions	L65*W48*H100 cm
Blades	6" - 3 Nylon + Fiberglass Blades	Voltage	1 Ø 110V, 60Hz	Water Capacity	48 L
Motor	1/3HP F Grade	Max Current	5A ±10	Weight	40 kg
Poles	4P	Max Power Consumption	300 W/hr ±10	Weight with Water	88 kg



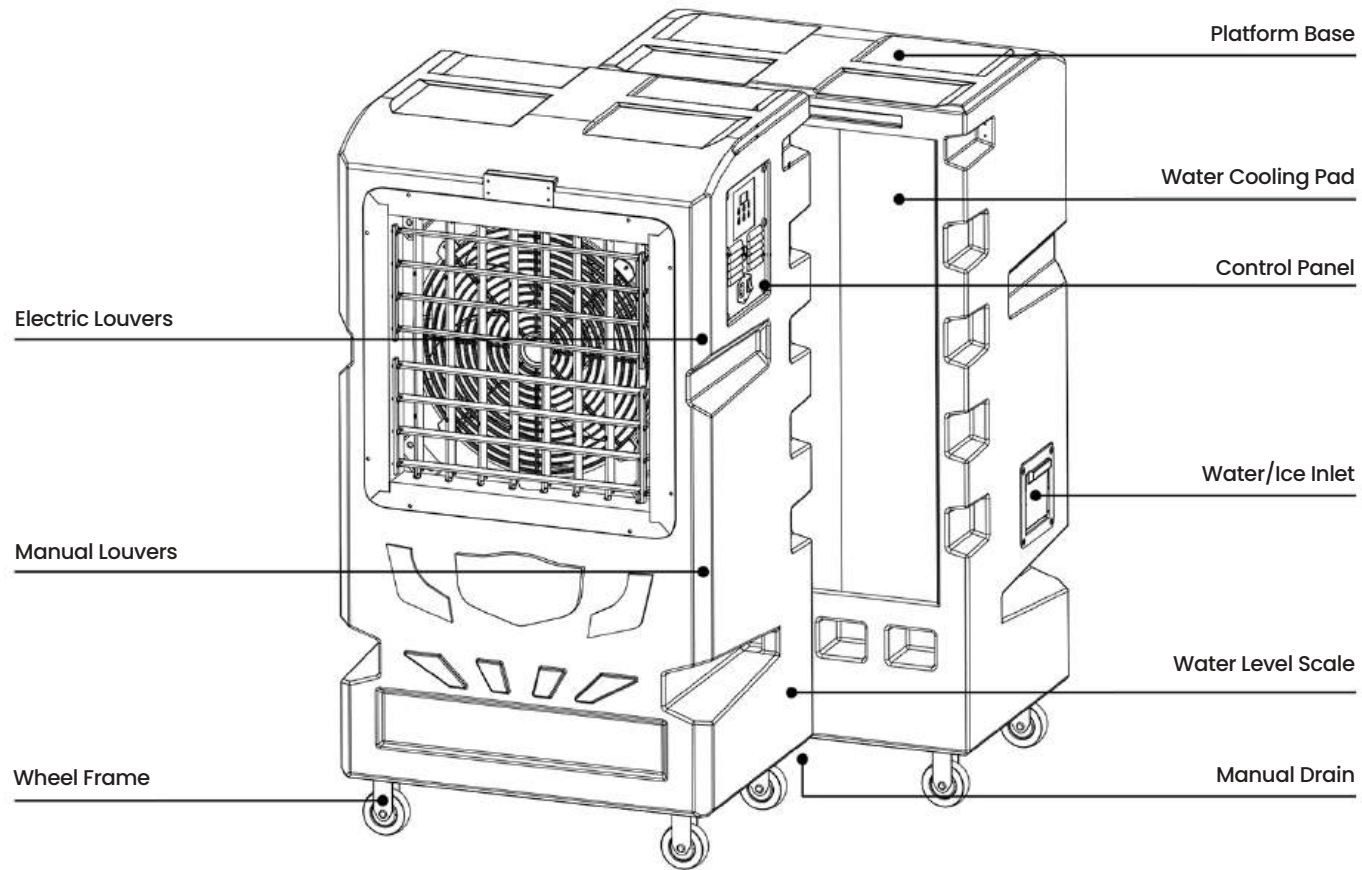

MODEL: BW090



INSTRUCTIONS

Water Cooling
Fan Operation
Guide



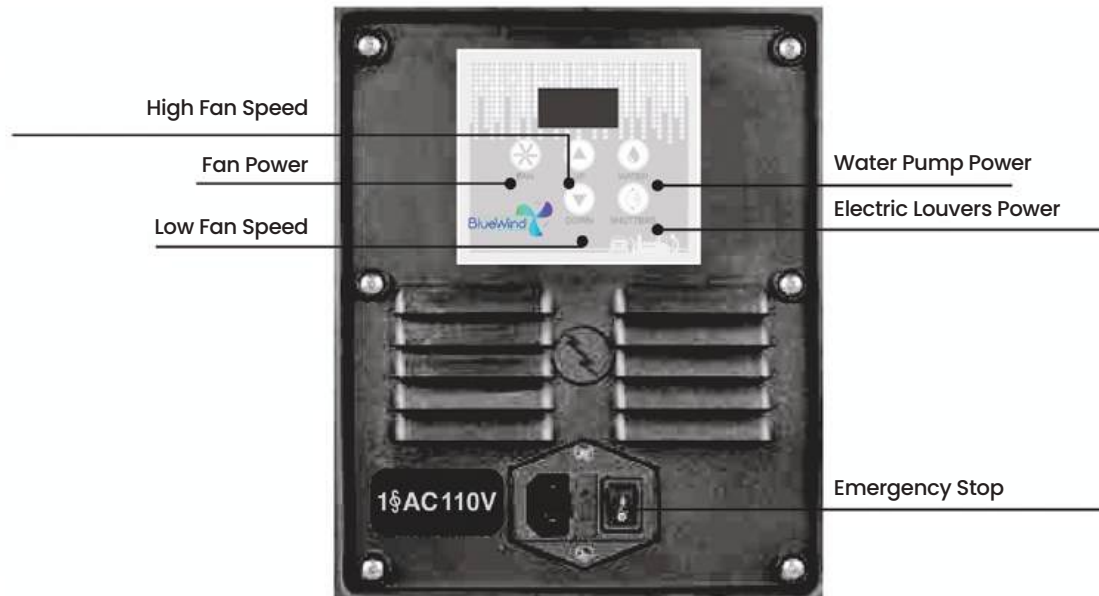

Operating Proce:

- 1 Open the water inlet to fill the tank. Turn on the water pump (refer to the control panel instructions below) and allow the water to soak the cooling pads for 1–2 minutes. Then, turn on the fan and adjust the speed as desired. Following this process will ensure optimal cooling performance.
- 2 Do not spray water on the control panel, as this may cause a short circuit.
- 3 Control Panel Instructions:





INSTRUCTIONS

A		<p>Start Emergency Stop</p>	<ul style="list-style-type: none"> •Press the power button to turn on the indicator light. •Press the emergency stop to turn off the fan in case of emergency. <p>For normal use, follow the power-on and power-off procedure indicated below.</p> <p>Attention: After pressing the emergency stop, wait 20 seconds before restarting the fan.</p>
B		<p>Pump power</p>	<p>Press the pump button: the pump will start only when the tank contains enough water. It will not operate if the water level is too low—fill the tank before use.</p>
C		<p>Fan on</p>	<p>Turn on the fan and use the speed regulator to control the airflow speed.</p>
D		<p>Fan speed regulator</p>	<p>The fan speed can be adjusted from 0 to 100; the higher the number, the greater the airflow power.</p>
E		<p>The power of electric blinds</p>	<p>Controls the electric louvers (if equipped).</p>



CLEANING AND MAINTENANCE



ATTENTION!
Before cleaning, turn off the unit, unplug it, and move it away from the power source.

CHANGE THE WATER REGULARLY



- 1 During use, dust and particles may accumulate inside the tank. This can reduce cooling efficiency and cause unpleasant odors. It is recommended to change the tank water at least once per week, or more frequently if needed. Do not spray water directly onto the inverter or control panel.
- 2 Because the unit filters dust and particles from the air, it's important to drain the water manually after each use in poor air environments. Refill the tank before the next use.
- 3 **Manual Drain**
To drain manually: Turn the drain knob located at the bottom of the unit to release the water. When finished, turn the knob again to close it.

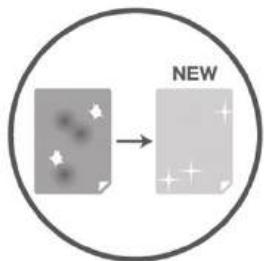

Filter Replacement:

Contact your distributor when the filter becomes stained or torn.

Water Maintenance:

Always replace the water regularly to ensure hygiene and prevent odor.



Precautions



- 1 Please read this manual carefully. Damages or injuries caused by improper use are not covered by the warranty.
- 2 BlueWind is not responsible for any accidents resulting from unauthorized modifications made by users.
- 3 If you notice any damage caused during transportation, contact your distributor for assistance.
- 4 To prevent accidents or damage, follow these rules:
Learn how to operate the unit correctly before use.
Read the entire user manual and understand all operating instructions.
Review all safety and label instructions before operating.

The contents of this manual, including product design and specifications, are subject to change without prior notice.
This manual is protected by law. All rights reserved by BlueWind.



INSTRUCTIONS

1 Please follow the instructions below:

- A  Connect the unit to AC 110V or AC 220V, 50/60 Hz single-phase power. (The product has a label indicating the proper voltage.)
- B  The voltage must not deviate more than $\pm 10\%$ from the indicated rating.
- C  Recommended operating temperature: 0°C to 45°C (32°F–113°F). Do not place the unit near heat or fire sources.

2 When the water level in the tank drops, the pump will automatically shut off. Fill the tank to the maximum level, but do not overfill.

3 Do not stand, sit, or place objects on the unit. This could cause damage, falls, or injuries if objects fall off.

4 After using the ice bucket, make sure to close it securely.

5 Do not remove the safety cover or any parts of the fan — doing so could cause damage or injury.

6 Use a properly insulated outlet or cable for the fan. Do not share the power source with other high-consumption equipment to ensure safety.

7 When the pump is off, the cooler can still function as a fan.

8 For better cooling performance, clean the filter and replace the tank water once a week. Open the manual drain valve at the bottom, then refill the tank after cleaning to prolong the pump's life. When the pump is turned off, the cooler can still be used as a fan only.



A. Caution: Before cleaning, turn off the unit, unplug it, and move it away from the power source and other devices.



B. Open the bottom drain and wash the filter with a soft brush from top to bottom. After washing, let the residual water drain completely before closing the drain.



C. Clean the unit with a damp cloth—do not spray water or use volatile liquids.



D. When cleaning the filter, do not spray water directly onto the control panel or housing. Doing so may damage the motor controller.



INSTRUCTIONS

9 Warranty Exclusions – The following damages are not covered:

- | | |
|--|--|
| <ul style="list-style-type: none"> A. Use with incorrect voltage. B. Damage caused by mishandling or transport by the user. C. Damage caused by natural disasters. D. Structural damage due to volatile liquids or gases. E. Accidents or damage caused by cable connection issues or sharing electricity with other devices. | <ul style="list-style-type: none"> F. Damage caused by modification or alteration of parts. G. Malfunction caused by changing internal wiring. H. Damage caused by spraying water or rain exposure. I. Pump failure due to blockage from lack of cleaning. |
|--|--|



Contact your dealer for more information.



Stepless fan speed control

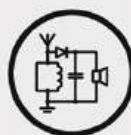

Short-circuit protection



Soft start motor



Low-water-level protection



Overcurrent protection



BlueWind Portable Inverter Evaporative Cooler Manual

www.bluewindfans.com

☎ (81) 8125-7300

12 DE ABRIL NO. 5411 / COL. TORRES DE LINDAVISTA / GUADALUPE, NUEVO LEÓN C.P. 67126

